

EVOLVE WALL VANITY 600 2 X DRAWER - CURVED VITREOUS  
CHINA DEZIGNA WHITE GLOSS

ELEMENTi

28310.11

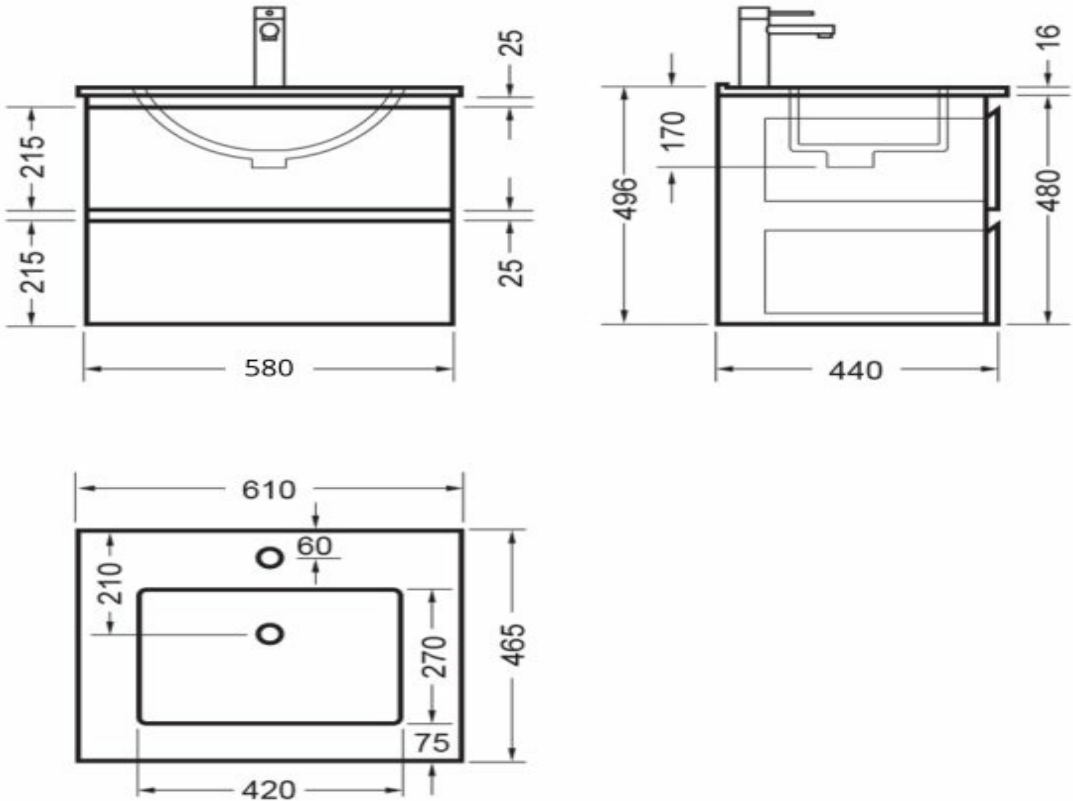

Residential/Light  
Commercial Use

Suitable for Residential/Light Commercial Use (Kitchens,  
Bathrooms and Laundries in Hotels, Motels and  
Retirement Villages).



Guarantee

5 Year Guarantee (Basin and  
Cabinet)



Guarantee

10 Year Guarantee (Tavolo Top)



Hafele Lifetime  
Warranty

All Hafele Hardware comes with a Lifetime Warranty.



Moisture Resistant

Made from Moisture Resistant Board





Soft Close Drawer  
System

Incorporates Soft Close Drawer and Doors.



Made in New  
Zealand

Designed & Engineered in New  
Zealand