

HPR10

Ritter Thermal Heat Pump, 10kW



Technical Specification

- Heating Capacity Range (kW): 4.7-12.5
- Max Power Input (kW): 4.6
- Max Current Input (Amps): 21.5
- Max Output Temp: 62°C
- COP 35-30°C @ 7°C: 4.47
- COP 45-40°C @ 7°C: 3.36
- COP 35-30°C @ 2°C: 3.92
- COP 45-40°C @ 2°C: 2.95
- Refrigerant: R32
- Noise Ranged B(A): 42-55
- Water Connection (Inch): 1
- Water Flow Volume (m³/h): 1.7
- Pump Pressure (m/H₂O): 5.5

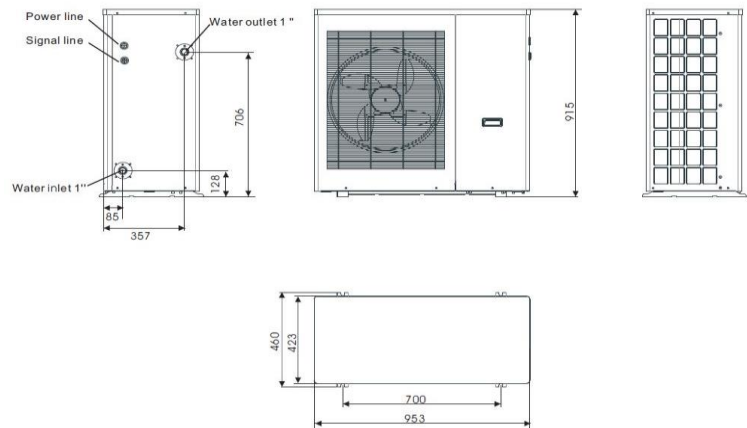

Warranty

5 years parts and labour

Features

Ritter thermal is an inverter air to water heat pump with R32 refrigerant and high efficiency, optimized for underfloor heating applications. High quality and efficient compressor, fan and water pump is used to ensure the low noise level with insulation.

The heat pump is designed with a full metal case without plastic grills as seen on most other units.

The PC microcomputer based controller is available for the users to review or set the running parameters of the heat pump with a smart phone and app control.

This series of heat pump is designed to work under different working conditions as low as -15 degrees for heating.