

INSTALLATION INSTRUCTIONS



Trusted in New Zealand Since 1982

BIDETS

Electronic Bidet

99286A-0



If you are building a bathroom from scratch, giving your bathroom a makeover or just replacing an old tap, Englefield can provide a solution for you.

Table of Contents

Safety Instructions	2 ~ 6	Before use
Operational Instructions	7	
Name of components	8 ~ 9	
Accessories	9	
Installation Instructions	10 ~ 12	Installation
Grounding Instructions	13	
Things to be checked after installation	14	
How to Use Basic Features	15	Operation
How to Use Additional Features	16 ~ 19	
How to take care of this Product	20 ~ 23	Care & Cleaning. Before you call for service
Prevention of Freezing	24 ~ 25	
Flickering Warning Signals	25	
Troubleshooting	26	
Specification	27	
Important Safeguards	28	

Safety Instructions

Be sure to observe the following

- Be sure to read the following safety instructions carefully and use the product only as instructed in this manual to prevent bodily injuries and/or property damage which might happen while using this product.
- Thoroughly understand each of the following symbols (marks and graphical signs), read all instructions and precautions and follow them.

 WARNING	Failure to observe any of the following might result in critical injury or death.	 CAUTION	Failure to observe any of the following might result in minor injury and/or product damage.
 Strictly prohibited.		 Be sure to unplug the electric power plug.	
 Never disassemble or modify this product.		 Do not place in or drop into water.	
 Proper grounding required to prevent electric shock.		 Things that have to be observed.	
 Never use wet hands.			

*1: Serious injury includes loss of eyesight, severe wound, burn (high, low temperature), electric shock, bone fracture, etc.

*2: Injury means minor wound, burn or electric shock.

*3: Property damage refers to extensive damage relating to house, furniture, livestock or pets, etc.

Exemption from liability

- Manufacturer takes no responsibility for any damages resulting from natural disasters such as earthquakes, lightning and wind damage and flooding, fires not caused by the manufacturer or the bidet product covered by this manual, other accidents, consumer mistakes and/or misuse and abuse of the product or the use of the product under abnormal conditions.
- Manufacturer takes no responsibility for any incidental damages resulting from the use of the product or inability to use the product (lost profits or suspension of business, etc.).
- Manufacturer takes no responsibility for any damages resulting from the failure to observe the contents contained in this manual.

WARNING

When children, the elderly or the invalid use the product, the seat temperature adjustment button should be set to OFF position.

Kids, the elderly, people with sensitive skin, people incapable of adjusting temperature on their own, people who have taken sleep-inducing medicine (sleeping pill or cold medicine, etc.) or people with hangover or severe weariness may sustain low temperature burn or injury.



CAUTION

"OFF"
for kids,
the elderly, etc



Do not scratch, crack, bend forcibly, twist or pull the electrical power cord. Do not apply heat to, or place heavy objects on, the cord.

Damaged power cord may lead to fire or electrical shock. Do not attempt to replace a damaged power cord on your own. Contact your nearest authorised service center for a replacement.



Prohibited

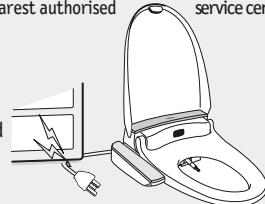

Use an electric wall outlet independently which is suitable for AC 240V, rating over 7 Ampere.

Use of extension cord or sharing an outlet with other products may lead to fire or electric shock.



Over 7A
Rating

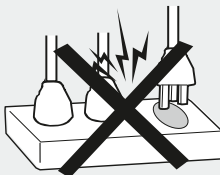

Never disassemble, repair or modify the product.

Doing so may cause fire, electrical shock or injury. Contact a nearest authorised service center for repair.



Disassembly
Prohibited

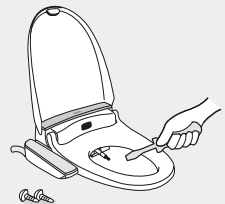

Never use a damaged power cord, damaged power plug, or a loose electrical outlet.

Doing so may result in fire, electric shock, short circuit, smoke generation or ignition.



Prohibited

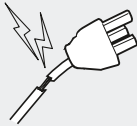

Power plug should be plugged into the wall outlet securely.

Failure to do so may result in electric short circuit, electric shock, smoke generation or ignition.



Insert securely

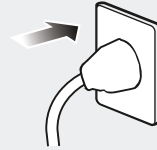

Disconnect the power plug from the wall outlet and drain water from water tank in the case that the product is not used over an extended period of time.

If not drained, the water may become contaminated.



Drain water

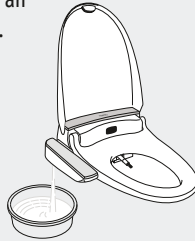

Do not water the product. Do not install the product in wet or damp places. (This product is intended for use on a toilet only, and should not be used for any other purpose).

Failure to observe may lead to electric shock, electric short circuit or fire.



Prohibited

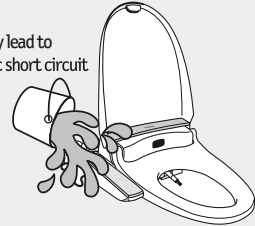

Use tap water or potable water only.

Using recycled water or industrial water may cause cystitis or irritation to skin.



Use tap water

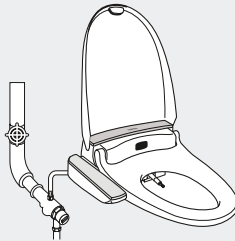

Do not spray water or wastewater into the unit or power plug.

Doing so may cause fire or electric shock.



Prohibited

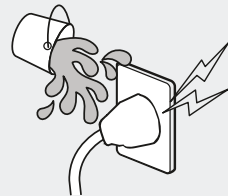

Keep the power plug dust-free by removing the dust using a dry cloth.

Failure to do so may cause a fire.



Wipe off



When plugging and unplugging the power plug, never use wet hands.

Doing so may lead to electric shock.



Wet hands prohibited

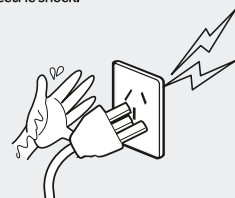

Before cleaning the product, always disconnect the power plug from the wall outlet.

Failure to do so may result in electric shock or injury.



Disconnect power plug

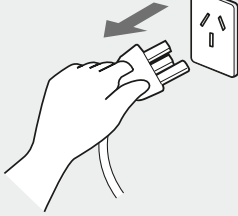

Discontinue using the product in case of malfunctioning. Disconnect the power plug from the electrical outlet and close the water valve if any of the following occur;

- Water leaks from either the main unit or the water pipe.
- The product makes odd noises or produces unpleasant odour.
- Abnormal heat from the main body.
- Fuming from main body.
- Crack or break on main body.

Continuing use of a malfunctioning product (as mentioned above) may lead to fire, electric shock or water leakage. Please contact the dealer or an authorised service centre for repair.

Safety Precaution



CAUTION

Please do not use the product for usage other than that described in this user manual.

Failure to do so may lead to fire, electric shock or injury.



Prohibited

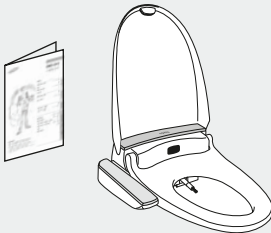

Grab the plug-knob for unplugging the power plug.

Failure to do so may result in electric shock, electric short circuit or fire.



Disconnect power plug

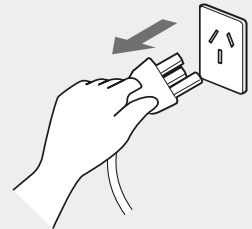

Do not put stove, heater, or cigarettes in or near the product.

Doing so may lead to fire, discolouration or malfunctioning.



Prohibited

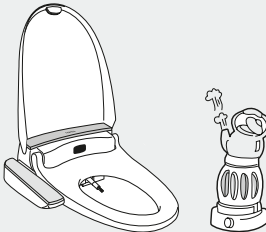

Do not rest against the seat cover when sitting on the seat.

This may cause the seat cover to break, which may lead to back injury if the user loses his/her balance and tumbles over.



Prohibited



Do not insert fingers into or block off the warm air blower outlet.

Doing so may result in burn or injury.



Prohibited

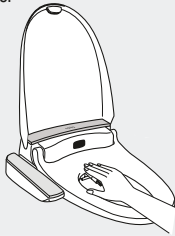

Do not spray water, insert fingers or other objects into warm air outlet or nozzle gate.

Doing so may lead to electric shock or product malfunctioning.



Prohibited



Do not let a child alone use this product. He/she may fall into the toilet bowl.

The child needs to be supervised by an adult.



CAUTION



Always press the control panel button while the seat is occupied.

Otherwise, the person standing by the product or the floor may get wet due to warm water coming out of nozzle.



CAUTION

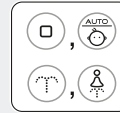

Shut off the water valve before removing the filtering mesh for cleaning.

Make sure to fasten it up after the cleaning.

Failure to observe may lead to water leakage.

(See page 21 for cleaning of the filtering mesh.)



Close

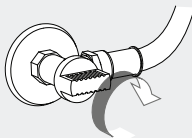

Do not pull forcibly or apply excessive force to the water feed hose.

Doing so may cause water to leak.



Prohibited

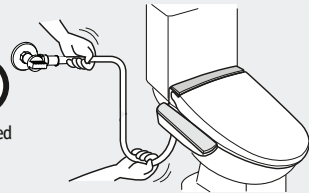

Select the installation place to be out of direct sunlight (ultraviolet rays).

Doing so may result in worsening of product surface such as discolouration or fading and/or product degradation.



Prohibited

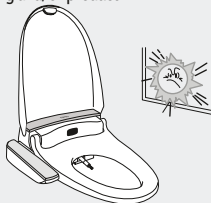

Do not stand on, or give a shock to, the main unit.

Doing so may lead to deformation or breakage of the product, resulting in bodily injury.



Prohibited

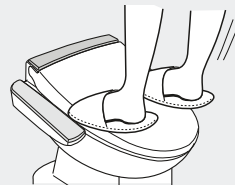

Never use acidic or alkaline bathroom detergent, benzene, thinner, cleanser or nylon scrubber when cleaning the product. Doing so may damage plastic or metallic parts.



Prohibited



Do not place or drop the product into water. It may lead to a product failure or electric shock.



Never place
in water

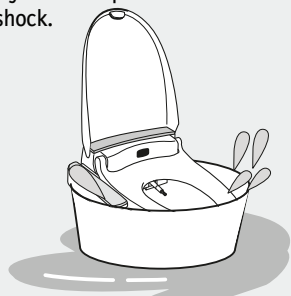

Keep warm

Freezing may break pipes, and may cause leakage. When freezing is highly expected, drain the water from the water tank.

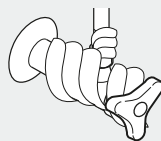

CAUTION

The user of this bidet product should not weigh more than 120kg.



CAUTION

Any person having a female-specific disorder, skin disorder or disease in the sensitive private area should consult a physician before using this product.
This product is not medical equipment.



CAUTION

Water pressure setting should be positioned to 'Low' or 'Very Low' when the product is used by a person having sensitive skin or a disease in the sensitive private area, the elderly, the invalid or the disabled.
Failure to do so may lead to damage to skin.



CAUTION for
usage

In the event that the bidet seat is to be reinstalled on a different toilet (ie: product relocation), close water valve, disconnect power plug from electrical outlet, and completely drain and remove water from the main unit before packaging the product for movement.

- If the product is moved with some water inside the main unit, water leakage from water tank may cause electric shock, fire or product failure.
- Please refer to page 28 of this manual concerning how to remove water from the main unit.
- Please contact the dealer or retailer where the product was purchased for further information.



WARNING

An in-line water filter must be used with this product. Failure to use this may void manufacturer's warranty.

Operational Instructions

- IMPORTANT:**
- * Connect to mains cold water supply only. Do not connect to hot water supply.
 - * Water supply pressure for normal operation: Min 220kPa - Max 500kPa.
 - * This douche seat is supplied with a low-medium hazard backflow protection device complying with AS/NZS 2845.1
 - * This device must be installed in accordance with AS/NZS 3500.1

Water supply to the toilet water tank may be interrupted if the ball-tap connecting screw is tightened, when disassembling the water pipe or connecting water feed hose.

Do not touch ball-tap connection screw.

Have a specialised plumber install the cold water feed pipe and the flush valve in the cold area.

Contact specialised technician.

Keep the unused water pipes for future use.

Do not open/close the toilet seat and cover with excessive force.

Doing so may lead to breakage or malfunction.

Water may keep running out of nozzle after cleansing. It does not indicate abnormality. It is residual water from inside the pipes.

It will stop after 2 minutes.

Drain water completely out of main unit and hoses to prevent possible water leakage and unplug the power cord when the product is not in use for a long time.

Wipe the main unit with a soft cloth when dirty.

Clean the main unit with a diluted neutral detergent using a soft cloth and wipe off the remainder with a damp cloth if it is excessively dirty.

When the product is operated while the toilet seat is not occupied be careful as water may splash. This can occur in the following cases,

- When a child intentionally presses a button,
- When a button is pressed during cleaning,
- When an object is placed on the control panel.

Small amount of water may run out of nozzles occasionally. It does not indicate abnormality. This occurs due to the expansion of water that gets warm in the water tank.

If water runs continuously in an unusual manner, shut off the valve, unplug the power cord and call the service centre or the dealer.

Cleansing water will not flow from the nozzle if the water pressure setting is set to 'low' and mains water pressure is low.

Please set the water pressure setting to 'high'.

Do not press the buttons on the control panel too hard when operating the product.

Doing so may lead to a failure.

Cleansing will be stopped automatically by the timer after about 50 seconds of use.

Push the button again if required.

Keep the nozzle and warm air blower outlet clean to prevent possible stains from urine.

It may cause malfunction.

Keep the nozzle clean against contamination.

It may cause bad odour or malfunction.

Deodourisation will stop automatically after 15 minutes of continuous use,

Please stand up and sit again for longer use. The main purpose of deodourisation is to remove the odour in the toilet bowl.

It's not for the whole bathroom.

Name of components

Front side of main unit

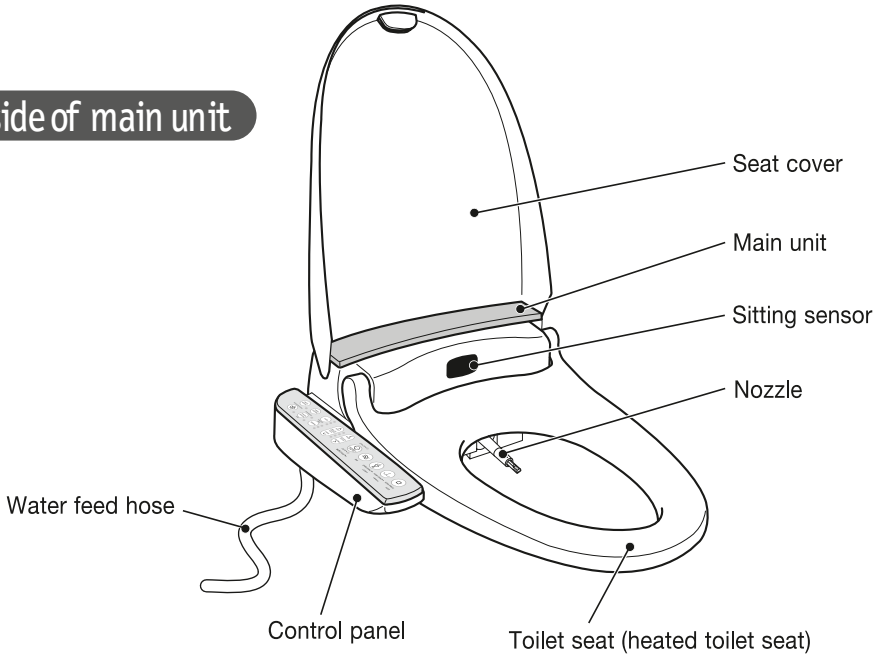

Rear side of main unit

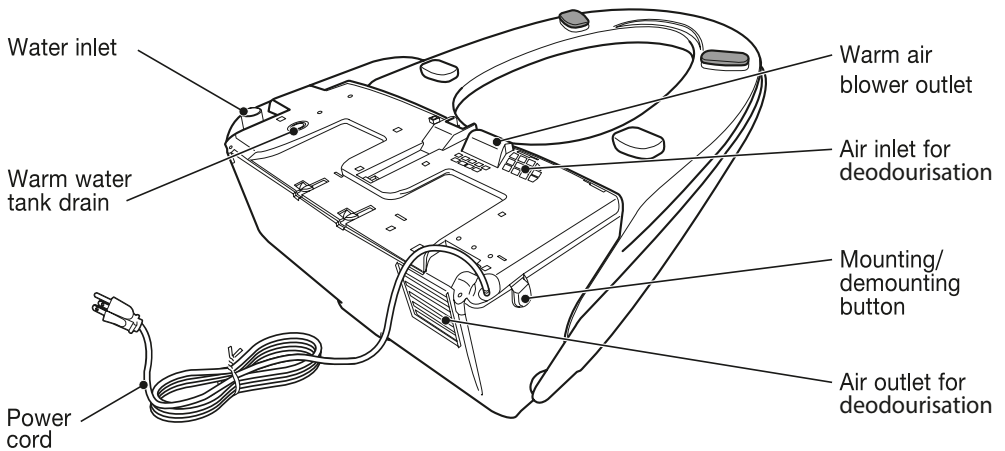

Control Panel

※ Control panel layout may vary depending on the models.

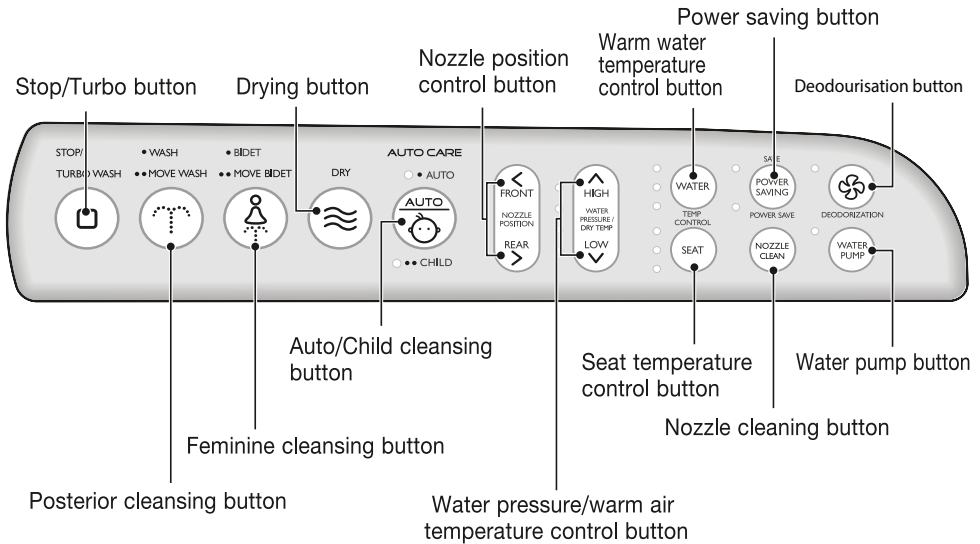

Before use

Accessories

Items required for installation

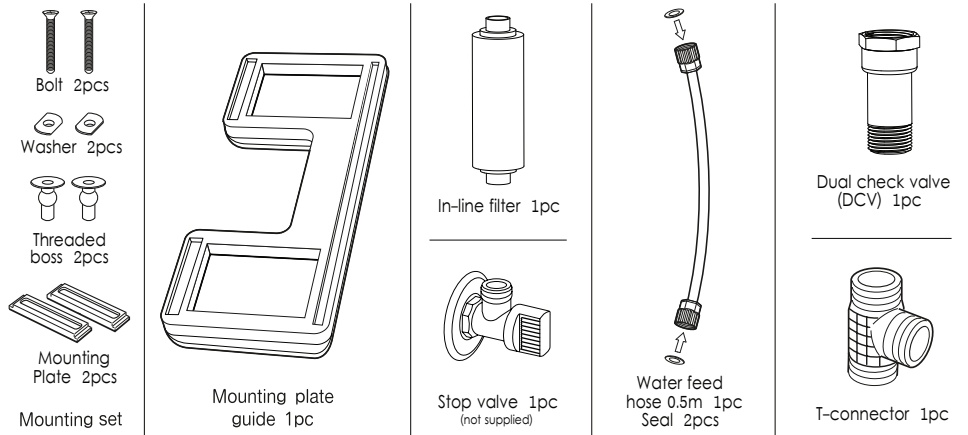

Installation Instructions

- Required tools: Phillips screwdriver
Adjustable crescent

IMPORTANT

This Bidet Douche Seat must be installed in accordance with AS/NZS 3500.1 Plumbing and Drainage - Water Services

1 Close water supply stop valve.

- Check if any other appliance uses water before closing the valve.

2 Remove the existing toilet seat.

- Remove the seat by untightening the nuts using a tool such as a spanner or crescent.
- For a normal installation where the bidet seat has its own water supply, proceed to step 4.

Note

- Keep the removed seat, seat cover, nuts, etc. in a safe place for future use just in case.

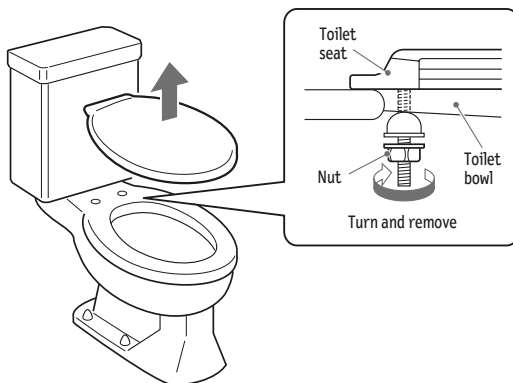

3 Installation for single water supply.

- A longer water feed hose may be required. Your plumber will be able to supply this.
 - For separate water supplies to the bidet and cistern, skip to Step 4.
1. Shut off the water mains and connect a stop valve to the water supply.
 2. Connect the dual check valve and the T-connector in this order.
 3. Connect the in-line filter to the water inlet on the main unit.
 4. Connect hoses from the legs of the T-connector to both the toilet cistern and in-line filter on the bidet seat.
 5. Reinststate the water supply and check for any leaks.

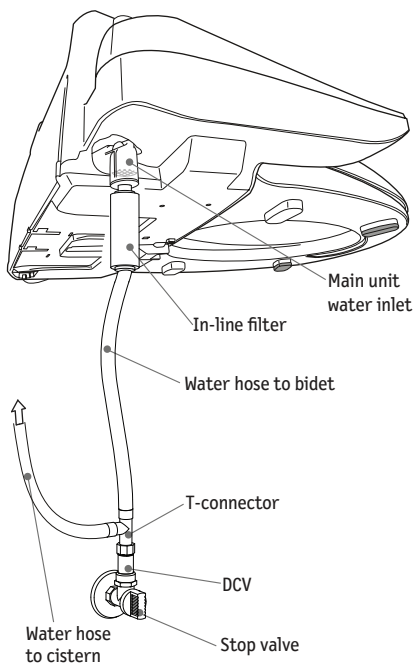

Installation Instructions

4 Installation with separate water supplies for the toilet tank and bidet seat.

1. Connect the dual check valve (DCV) to the stop valve.
2. Connect the in-line filter to the water inlet on the main unit.
3. Connect the water feed hose between the filter and DCV.

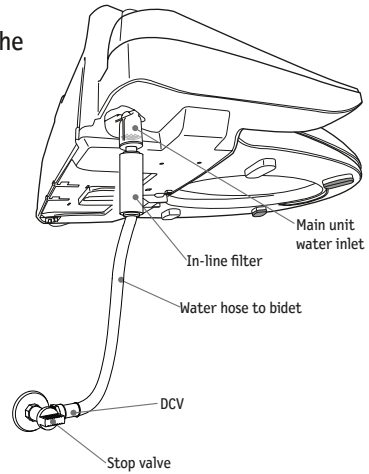

5 Install the main unit.

Note

- In a retrofit installation, the existing seat mounts may need to be removed.

1. Insert the threaded bosses into the seat mounting holes in the pan.
2. Pass the mounting bolts through the washers and mounting plates. Then locate mounting plates inside the guide, as shown.
3. Screw the mounting bolts in and tighten with a screwdriver.

Note

- Over time, the screw bolts may get loose. In such case, tighten the bolts again with a screwdriver.



- ① The distance between the bolts can be adjusted depending on the hole locations on the toilet bowl.
- ② Carefully align the centers of the main unit and toilet bowl when attaching.

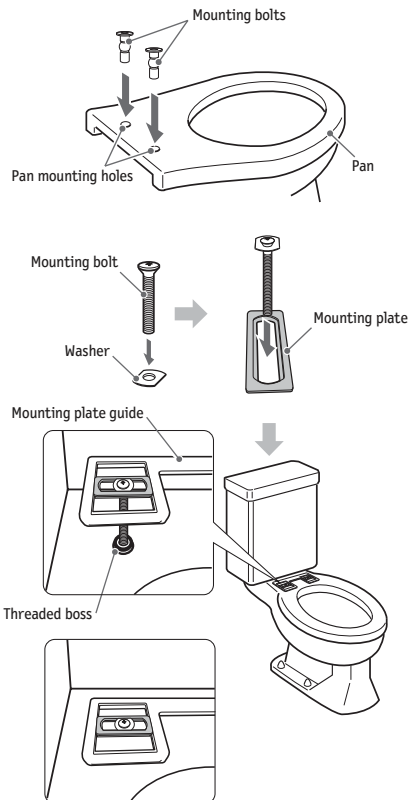

Installation Instructions

5. Align the center of main unit to the center of the plate guide and push it all the way back until you hear a 'click' sound.

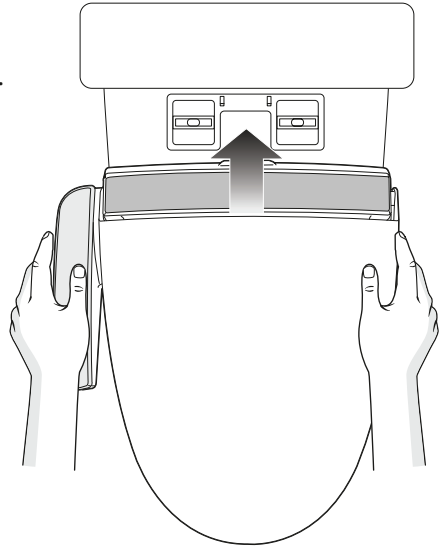

6. Check that the main unit does not easily come off by moving the unit in four different directions.

- When the main unit is installed to the toilet bowl, it may be a little movable, which does not indicate abnormality. This happens with the removable type of main unit.

Note

- The main unit may become heavily movable if used over an extended period of time due to loose bolts. Fully tighten the bolts if this happens.

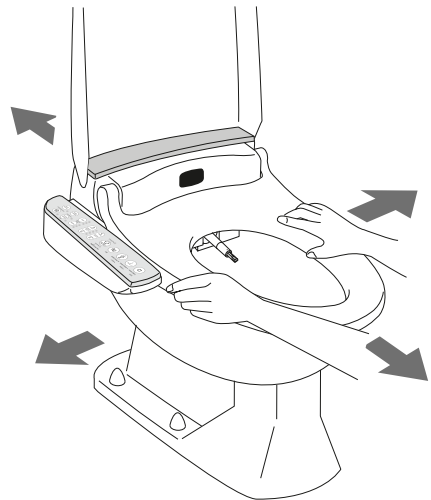

Grounding Instructions

This product should be grounded. In the event of an electrical short circuit, grounding reduces the risk of electric shock by providing an escape wire for the electric current. This product is equipped with a cord having a grounding wire with a grounding plug. The plug must be plugged into an outlet that is properly installed by a suitably qualified electrician, and grounded.

DANGER - Improper use of the grounding plug can result in a risk of electric shock.

If repair or replacement of the cord or plug is necessary, do not connect the grounding wire to either flat blade terminal. The wire with insulation having an outer surface that is green (with or without yellow stripes) is the grounding wire.

Check with a qualified electrician or serviceman if the grounding instructions are not completely understood, or if in doubt as to whether the product is properly grounded.

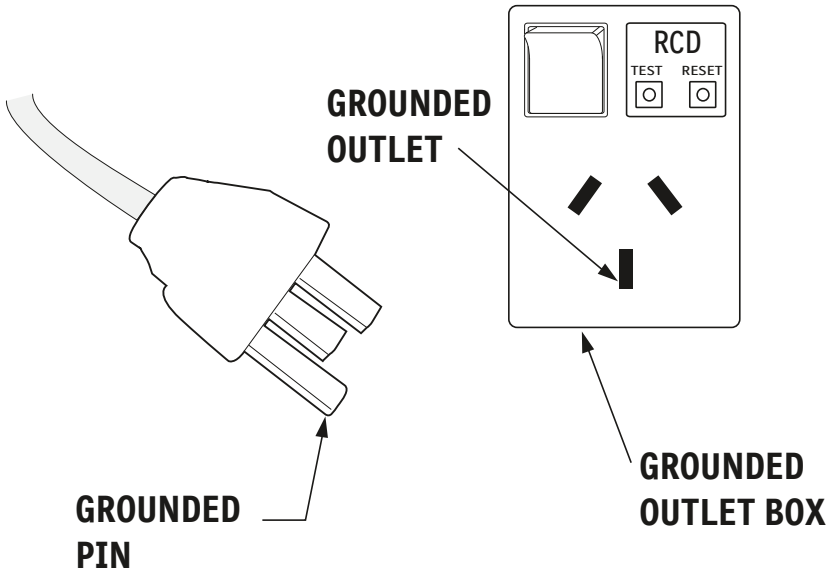

Things to be checked after installation

Check for water leakage

Check for water leakage from any of the pipe connections after installation.

Inspection points

- Check if there are any loose connections or joints before turning on the water valve.
1. Open water valve.
 2. Open water feed valve and check if water leaks from any pipe joints.

If water leaks



1. Close water valve.
2. Disassemble the joint where water is leaking and connect properly again.

Note

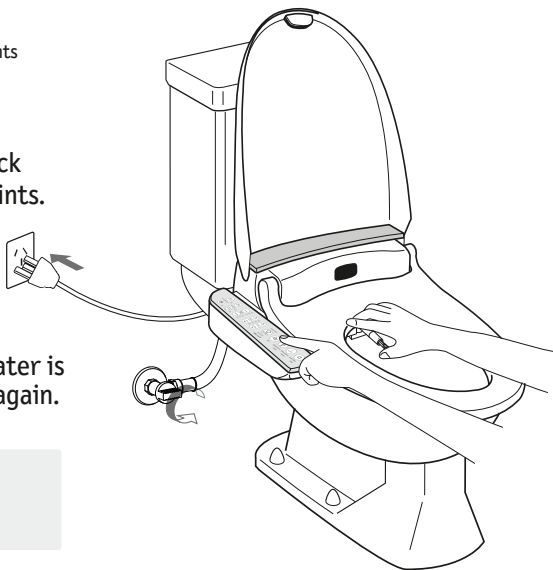
- If water continues leaking, close water valve and contact your nearest authorised service center.



Operational Check

1. Open mains water valve (Applicable only when closed).
2. Open water feed stop valve.
 - Check if water leaks from pipe, water tank hose or water feed hose joints. If water leaks, close the water feed valve, separate the valve and check if rubber packing is inserted. If not, insert the packing and reassemble the water feed valve.
3. Connect the power plug to the wall outlet.
 - Nozzle extends and retracts once, and the control panel lamps keep blinking (at initial operation).
4. Press  button on the control panel.
 - Water pressure/Dry Air lamp goes off when the tank is full of water, and Seat Temperature, Water Temperature and Water Pressure are set to Low, respectively.
 - Wait until cleansing water gets warm (takes about 5 minutes).
 - Check if the seat gets warm, too.
5. Approach hands to sitting sensor (within 5 cm) so that it may be activated.
6. If the tank is full of water, press  button one more time and check if the posterior cleansing system is operating correctly.
 - Check if nozzle extends and discharges warm water.
(Cover up the nozzle to prevent water from spraying outside.)
7. After confirming that warm water is coming from the nozzle, press stop button or deactivate the sitting sensor so that the operation may be stopped.
 - Cleansing operation stops and nozzle retracts.

How to use the basic features

⚠ WARNING



Set the Seat Temp control button to "OFF" or "LOW" if the product is used by the following persons:

- Young children, the aged or users incapable of setting the temperature themselves.
- People with sensitive or irritated skin,
- People having taken sleep-inducing medicine such as sleeping pills or cold medicine,
- People suffering from hangover or severe physical fatigue.

Failure to do so may lead to the low temperature burn or injury.

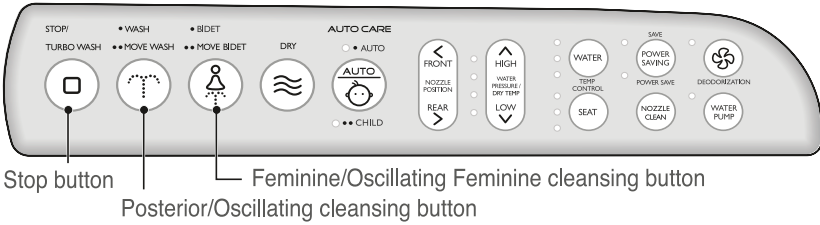

Posterior/Feminine cleansing

1 Sit on the seat.

2 Press or button.

- Nozzle cleaning starts when cleansing or bidet button is pressed.
- Nozzle position can be adjusted as desired when nozzle position control button is used.
- The continuous operation of the cleansing or bidet function will deplete the supply of warm cleansing water, dropping the water temperature. It is recommended that the cleansing or bidet function be stopped and only used again after the cleansing water gets warm.
- Water temperature and/or seat temperature may be adjusted while cleansing or bidet function is used.

Note

- Do not apply excessive force when pressing a button. Doing so may make the button inoperable.

Oscillating cleansing/Oscillating bidet cleansing

3 Press or button while cleansing or bidet cleansing to activate the oscillating function.

- Nozzle moves back and forth to provide cleansing of a wider area.
- Press cleansing or bidet button to deactivate the oscillation function.



4 Press button to stop the cleansing.

- Cleansing or bidet light will turn off. Nozzle moves back and forth 3 times around the nozzle inlet for self-cleaning.
- Cleansing or bidet cleansing function may not be selected during the self cleaning process.
- Press cleansing or bidet button one or more times to deactivate the oscillation function.

Note

- Continued use of cleansing for more than 50 seconds will activate the timer thus stopping the cleansing operation automatically. For continued operation, press the cleansing button again.

5 Stand up from seat.

- Note**
- Water coming out of the nozzle right after the cleansing operation does not indicate a product failure. It stops about two minutes after the remaining water in the hose has completely drained.
 - The occasional small amount of water running out of the nozzle does not indicate a product failure. This occurs because of warm water expansion in the water tank.
 - If the water runs continuously in an unusual manner, contact your nearest authorised service center after closing the water valve and disconnecting the power plug from the wall outlet.

How to use the additional features

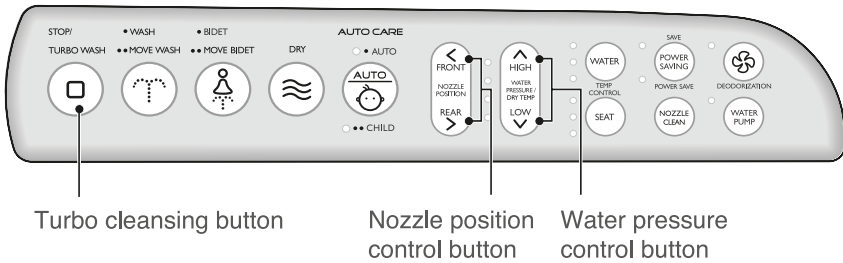



Turbo cleansing button

Nozzle position control button

Water pressure control button

Turbo cleansing

Upon sitting on the toilet seat, press  button in advance.

- Warm cleansing water is sprayed and touches the skin producing a massaging effect while the nozzle moves back and forth.
- Warm water is sprayed for 50 seconds with water pressure set to “HI”. You may reset the level of pressure during the turbo cleansing operation.
- If you are ready to use the toilet press the  button to stop the turbo operation.

Nozzle position control

Press  button while cleansing or bidet cleansing is operating.

- Initially nozzle is positioned in the center and it moves three steps forward and 3 steps backwards during cleansing or bidet cleansing operation.

Note

- The nozzle position used the last time is not automatically saved. The nozzle returns to its initial position (center) once the cleansing or bidet cleansing operation is complete. Therefore, you need to reset the nozzle position each time you use the product.

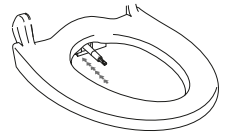

Water pressure control

Press  button to set the water pressure level.

- There are 4 water pressure level options.
- Unless changed, the current water pressure level setting will be used.
- If the water pressure level setting is changed the new setting will be saved.

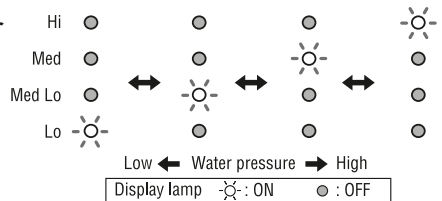

How to use the additional features

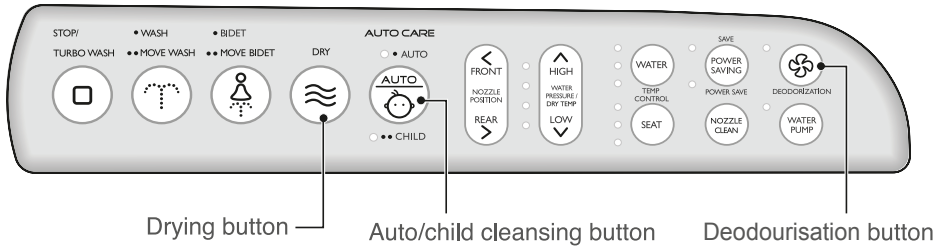

Drying button

Auto/child cleansing button

Deodourisation button

Auto/child cleansing



For auto cleansing operation, press the button only once.



For child cleansing operation, press the button twice.

- 50 seconds of oscillating cleansing followed by 2 minutes of drying then stops.
- Saved water and toilet seat temperatures are used.
- Water pressure level is changed automatically to produce a massaging effect.

- The button needs to be pressed within 3 seconds.
- 50 seconds of oscillating cleansing followed by 2 minutes of drying then stops.
- During this operation, water, drying air and seat temperatures are automatically set to medium.

Deodourisation

Press  button.

- Deodourisation light will turn "ON" and deodourisation will start.
- Press the deodourisation button to activate or deactivate this function on or off.
- When the seat is occupied and the sitting sensor is activated, deodourisation will start.
- When the sitting sensor is deactivated, deodourisation will continue for about 1 minute.
- If the button is pressed during operation the deodourisation operation will stop, the light will turn "OFF" and the setting will be cancelled.

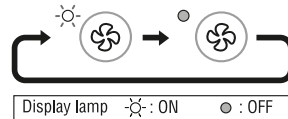

Note

- Deodourisation time is 15 minutes as a maximum, which means that the deodourisation stops in 15 minutes even if the sitting sensor is still activated.
- Deodourisation filter located inside the main unit.

Drying

Press  button.

- To stop the drying operation press  button
- Drying operation will stop automatically in 5 minutes. Press the button again for continuous drying operation.
- Using dry tissue to remove moisture before drying operation will help to reduce the drying time.

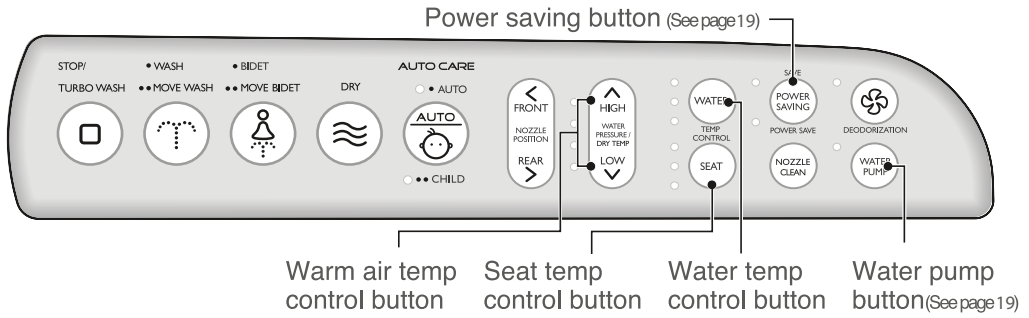

Air temperature control

Press button.

- To set the air temperature, press the water pressure/air temp button.
- There are 5 air temperature level options including heater OFF.
- Air temperature cannot be set after the drying operation has finished. Be sure to set the air temperature right after pressing the dryer button.

Display lamp : ON : OFF

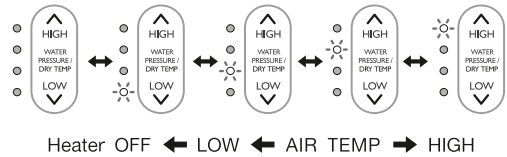

Water temperature control

Press button.

- There are 4 water temperature level options including water heater OFF.
- The temperature setting is changed each time the button is pressed.

Display lamp : ON : OFF



Seat temperature control

Press button.

- There are 4 seat temperature level options including seat heater OFF.
- The temperature setting is changed each time the button is pressed.
- Low temperature burn prevention feature.

Display lamp : ON : OFF

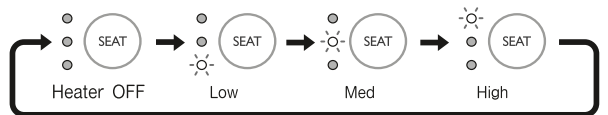

This feature automatically lowers the toilet seat temperature from the 'HIGH' setting to the 'MEDIUM' 10 minutes after the seat has been vacated.

Note • Actual seat temperature depends on the ambient temperature. Keep the seat cover closed to keep the seat warm and conserve energy.

Power saving mode

Press  button.

- Pressing the button once will set Lo Econo. Pressing the button a second time will set Hi Econo. Pressing the button a third time will cancel power-saving mode.

● Lo Econo

- When the product is not in use the water temperature will be 25°C and the seat temperature will be 28°C irrespective of the settings. (Power is saved through a shorter application time of current unless water and seat temperature are set to OFF.)
- When cleansing, bidet cleansing, auto/child cleansing, turbo cleansing or drying is activated, water and seat temp are raised to the set temperature by applying electricity. (It takes about 5 minutes to get to the set temperature).
- When cleansing, bidet cleansing, auto/child cleansing, turbo cleansing or drying operation is finished, water and seat temp are again set to 25°C and 28°C respectively.

● Hi Econo

- When the product is not in use, electric power is cut off to the water and seat heaters regardless of their settings.
- When cleansing, bidet cleansing, auto/child cleansing, turbo cleansing or drying is activated, water and seat temp are raised to the set temperature by applying electricity. (It takes about 5 minutes to get to the set temperature).
- When cleansing, bidet cleansing, auto/child cleansing, turbo cleansing or drying operation is finished, water and seat heaters are turned off again.

Other tips for saving electric power

Refer to the following methods for power saving.

- **Keep seat the cover closed when the product is not in use.**

Keeping the seat cover closed will help reduce power consumption as loss of heat from the seat is decreased.

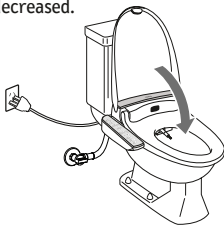

- **Set a lower temperature**

Set a lower temperature whenever possible.

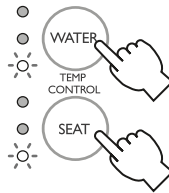

- **Unplug the power plug**

Disconnect the power plug when the product is not used over an extended period of time.

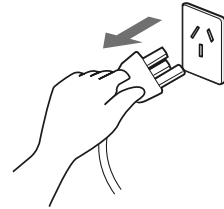

Water pump

Press  button.

- When the pump light is ON the pump will operate to increase water pressure during cleansing, bidet cleansing, auto/child cleansing and turbo cleansing. (If the pressure level is too high, adjust the level using the water pressure control button).
- When the pump light is OFF the pump will not operate. (Initially the product is set to pump OFF.)
- If the pressure reaches 14.2 psi (1.0 Kg/cm²), the pressure level will remain the same even if the pump operates.
- If the pressure is too high, stop the pump operation as it may lead to injury.

How to take care of this product

WARNING



Disconnect the power plug while cleaning the product

Disconnect power plug Failure to do so may cause electric shock or injury

CAUTION



Prohibited

Never use acidic or alkaline toilet detergent, benzene, thinner, cleanser or nylon scrubber when cleaning the product

Doing so may damage plastic or metallic parts.

Main unit

1. Disconnect the power plug from the wall outlet.
2. Use a soft and wet (with water) cloth only when cleaning the unit
3. Clean with a soft and wet (with neutral detergent) cloth if the unit is very dirty, and wipe off the detergent with a wet (with water) cloth.

Check the detergent type before using the detergent.

Seat cover may be separated for cleaning.

4. Connect the power plug to the wall outlet after cleaning is complete.

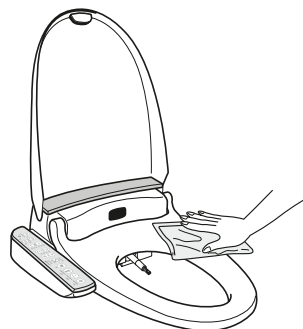

Separation and reassembly of toilet seat cover

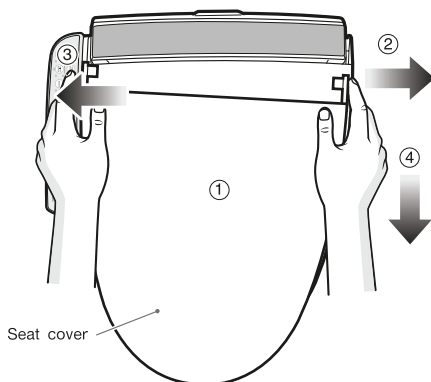

Separation

- ① Close the cover.
- ② Stretch out the right hand shaft of the seat cover.
- ③ Pull out the left hand shaft of the seat cover.
- ④ Remove the seat cover.

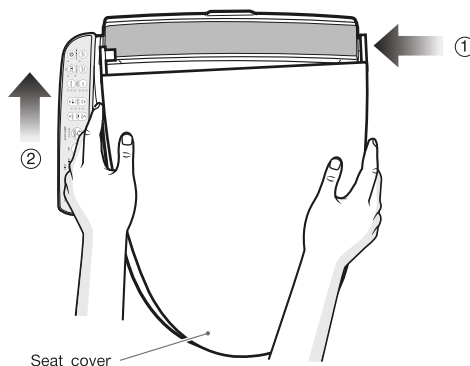

Reassembly

- ① Insert the right hand shaft of the seat cover to the right hand side of main unit.
- ② Insert the left hand shaft of the seat cover to the left hand side of main unit.

Note

- Do not close the toilet seat or seat cover forcibly. Doing so may damage the rotation shaft, thus preventing easy opening and closing.

How to take care of this product

CAUTION



Close the water valve before removing the filtering mesh. The filtering mesh should be installed securely after cleaning to avoid water leakage.

Close

Failure to do so may cause water leakage.

Cleaning filter net

1 Disconnect the power plug from the wall outlet.

2 Close the water feed valve.

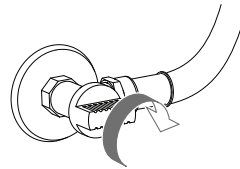

3 Separate water feed hose and filter from the main unit.

- Be careful so that the floor does not get wet due to water remaining inside the hose.

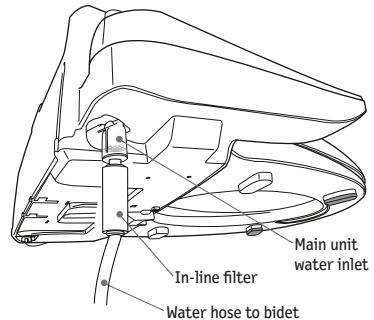

4 Clean inside the filtering mesh using a toothbrush, etc.

- The filtering mesh is built into the water feed inlet of the main unit.

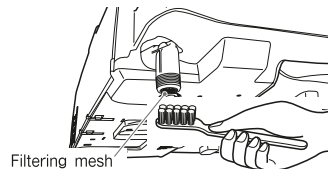

5 Connect the water feed hose and filter to the main unit and open the water feed valve.

- Check for leaks.

6 Connect the power plug to the wall socket.

Nozzle cleaning

1 Connect the power plug to wall outlet.

2 Open the seat cover and toilet seat.

3 Press **NOZZLE CLEAN** button on the control panel.

- Nozzle moves back and forth 3 times for self-cleaning and stops moving while fully extended.

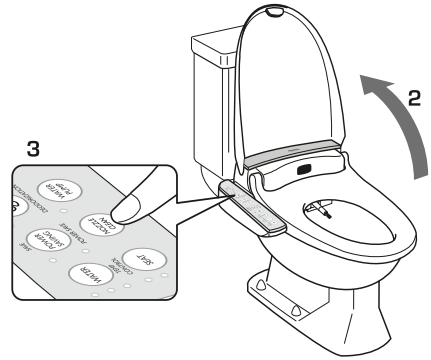

4 Clean the nozzle while it is fully extended.

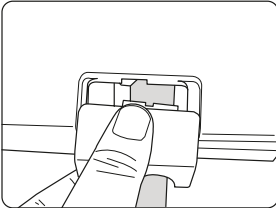

1. Separate the nozzle cleaning cover.

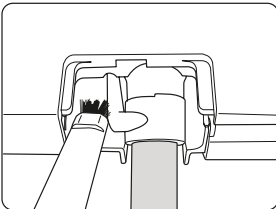

2. Put a soft wet sponge, brush or cloth inside.

Note • Be careful not to get any water into the warm air outlet.

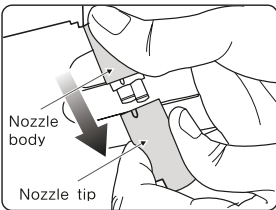

3. Pull the nozzle tip from the nozzle body while holding the nozzle body and separate the tip.

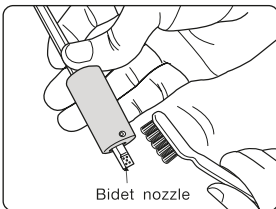

4. Using a tool inside the separated tip, push the bidet nozzle so that it may be cleaned with a soft sponge, brush or cloth.

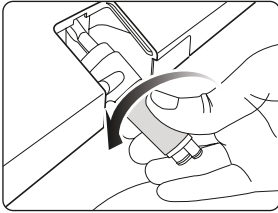

5. Rotate the stainless steel part of the nozzle body counterclockwise and separate it so that it may be cleaned with a sponge, etc.

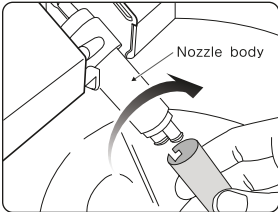

6. To put the stainless steel part back onto the nozzle body, rotate the stainless steel part clockwise with the hole facing downwards.

Note • Make sure the stainless steel part is secure.

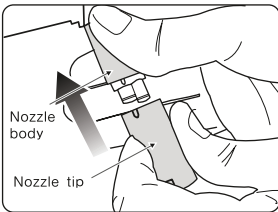



7. Put the cleaned nozzle tip back onto the nozzle body while holding the nozzle body.

Note

- Do not damage the nozzle hole.
- Do not apply excessive force to the nozzle.
- Do not separate and clean the nozzle too often. Doing so may cause a problem.
- Cleansing nozzle tip is assembled a little tightly to ensure air-tightness.
- Be careful so that no bodily injury may occur when separating the nozzle tip for cleaning.

5

Press  button on the control panel.

- Nozzle retracts only when  button is pressed after cleaning is done.

Note

- There may be a strange sound when nozzle retracts which does not indicate product failure.

6

Put the nozzle cleaning cover back and slowly close the toilet seat and cover.

How to prevent freezing and to care for the product when it's not in use over an extended period of time

Remove moisture around the water feed system as freezing may lead to a breakage of the system, Remove moisture when the product is not in use for an extended period of time. Water may become spoiled causing skin irritation.

Prevention of freezing and long-term care for the product

1 Unplug the power plug.

- Disconnect the plug from the wall outlet.

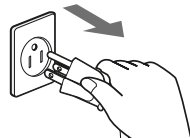

2 Close the water valve

- Turn the handle clockwise to shut off water.

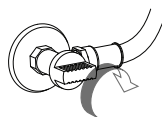

3 Drain the warm water tank.

- Drain water from the tank after rotating and removing the drain plug while lifting and holding the main unit mounting button. Use no less than a 2L container to drain the water into.
- Put the drain plug back after completely draining the water from the tank.

※ Use a large coin or washer if the water tank cap is not opened easily.

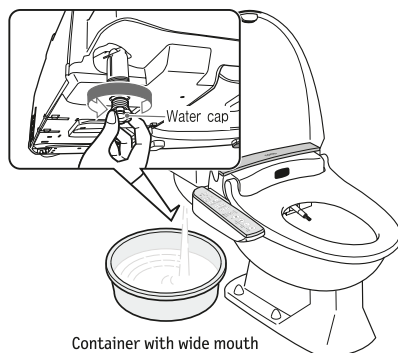

4 Drain the water from inside the feed hose.

- Disconnect the water feed hose from the in-line filter and place the end of the hose in a container for holding water.

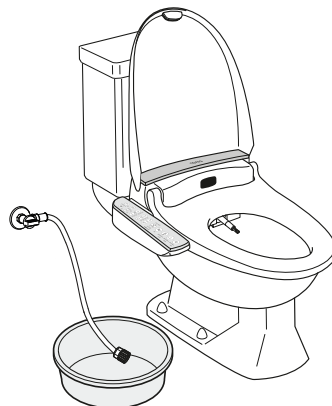
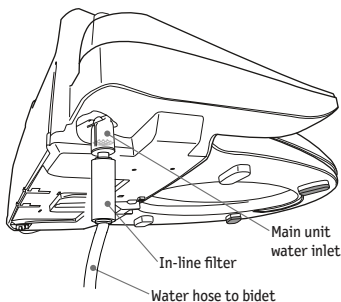

How to cancel the freezing prevention arrangement and to start to use the product again

- 1** Put the drain plug back into the water tank.

- 2** Connect the water feed hose as it was originally. (Refer to installation instructions.)
 - Check and make sure there is packing in the hose joint before connecting the hose.

- 3** Open the water feed valve.

- 4** Connect the power plug to the wall outlet.
 - Press the cleansing button to fill the tank with water.

Flickering warning lights.

The indicator light flickers when there is a problem with the main unit.

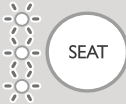
Display	Estimated cause and action to be taken	
	<ul style="list-style-type: none"> • Trouble with water temperature. • Inability to control warm water temperature due to water temperature sensor failure. 	<p>Stop using the product and contact your nearest authorised service center for a repair service.</p>
	<ul style="list-style-type: none"> • Trouble with seat temperature. • Inability to control seat temperature due to seat temperature sensor failure. 	
<p>All lamps are blinking</p>	<ul style="list-style-type: none"> • No water or water shortage in the tank. • Inability to control water level due to malfunctioning water level sensor. 	<p>Disconnect the plug and reconnect. Then press cleansing button to fill the tank with water. If the light still flickers, disconnect the plug and contact your nearest authorised service center.</p>

Display lamp  : ON  : OFF

Trouble Shooting

Status	Cause	How to handle
Product not working.	<ul style="list-style-type: none"> • Check power outage. • Check if circuit breaker operated. • Check if the plug is plugged in. • Check if power is cut off by the use of power button. 	<ul style="list-style-type: none"> • Wait for power restoration. • Disconnect the plug and reconnect. • Connect the plug. • Press power button if power is cut off.
Cleansing water not coming.	<ul style="list-style-type: none"> • Check water supply. • Check if water feed valve is closed. • Check if water feed hose is frozen. • Check if all lamps are blinking. 	<ul style="list-style-type: none"> • Wait for water service to resume. • Open water feed valve. • Make the frozen part warm using hot and wet cloth or make the room warmer to unfreeze. (Do not unfreeze using hot water or hot air. It may cause a breakage of the hose.) • Contact authorised service center.
Water pressure too weak.	<ul style="list-style-type: none"> • Check any foreign material in filtering mesh. • Check if water feed hose is forcibly bent. • Check if nozzle opening is clogged. • Check if water pressure is set to Lo. • Check if tap water pressure is less than 220kPa. 	<ul style="list-style-type: none"> • Clean the mesh. • Straighten the hose. • Clean the nozzle opening. • Set the pressure to Hi. • Water pressure should be between 220~500kPa.
Cleansing water not sufficiently warm	<ul style="list-style-type: none"> • Check if water temperature is set to OFF or Lo. • Check if cleansing is used continuously. • Check if Econo mode is set. • Check if power is cut off by the use of power button. 	<ul style="list-style-type: none"> • Set the temperature to Med or Hi. • Wait at least 5 to 7 minutes after the cleansing function is used by a different user (to make tank water warm.) • Cancel the power saving mode (Water in tank gets warm.) • Press power button.
Seat not sufficiently warm.	<ul style="list-style-type: none"> • Check if seat temperature is set to OFF or Lo. • Check if Econo mode is set. • Check if power is cut off by the use of power button. 	<ul style="list-style-type: none"> • Set the seat temperature to Med or Hi. • Wait about 5 minutes after occupying the seat (to make the seat warm.) • Press power button.
Main unit does not sit on the toilet bowl securely.	<ul style="list-style-type: none"> • Check if mounting bolt is tightened securely. 	<ul style="list-style-type: none"> • Tighten the screw. • Check the main unit installation and correct the problem if any.
Seat or cover does not close smoothly and gently.	<ul style="list-style-type: none"> • This happens when ambient temperature is high or when the product becomes aged over time. 	<ul style="list-style-type: none"> • If this happens regardless of season, contact authorized service center.
Air temperature too low.	<ul style="list-style-type: none"> • Check if air temperature is set to Lo. 	<ul style="list-style-type: none"> • Set the temperature to Med or Hi.
Drying stops during operation.	<ul style="list-style-type: none"> • Check if five or more minutes have passed since the dryer button was pressed. 	<ul style="list-style-type: none"> • Press dryer button again.

*Time required for water to get warm depends on ambient temperature.

Specifications

	Power Source	AC 220~240V, 50Hz
	Rated Power Consumption	1350W
	Effective Tap Water Pressure Range	220~500kPa.
	Effective Tap Water Temperature Range	Approx. 5°C ~ 35°C
Warm Water Cleansing Device	Posterior Cleansing	0.5~0.7L/min
	Feminine Cleansing	0.5~0.7L/min
	Water Pressure Control	4 Phases each for Posterior/Feminine Cleansing <small>(Low-Med Low-Medium-High)</small>
	Temperature Control	3 Phases (Approx. 33°C~40°C) of control and Heater-off
	Nozzle Location Control	6 Positions for each of Posterior and Feminine Cleansing
	Water Heater	1300W
	Water Tank Capacity	Approx. 0.67L
	Safety Device	Thermo s/w (prevention of overheating), Temperature fuse, Water level sensor
Toilet Seat Heater	Temperature Control	3 Phases (Approx. 33°C~39°C) of control and Heater-off
	Toilet Seat Heater	50W
	Safety Device	Temperature fuse
Dryer Device	Temperature Control	4 Phases (Approx. 35°C~55°C) of control and Heater-off
	Dryer Heater	290W
	Air Velocity	Approx. 15m/s
	Safety Device	Temperature fuse, Bimetal
Comfort Features	Deodorization	○
	Water Filter	○
	Water Pressure Pump	○
	Power Saving Mode	Lo Econo, Hi Econo
	Additional safety Devices	Built-in Circuit Breaker
	Exterior Dimension	487mm(Width) × 505mm(Length) × 154mm(Height)
	Net Weight	Approx. 4.8kg
	Length of Power Cord	Approx 1.5m

Important Safeguards

When using electrical products, especially when children are present, basic safety precautions should always be followed, including the following :

DANGER - To reduce the risk of electrocution:

1. Always unplug this product immediately after using.
2. Do not use while bathing.
3. Do not place or store product where it can fall or be pulled into a tub or sink.
4. Do not place in or drop into water or other liquid.
5. Do not reach for a product that has fallen into water. Unplug immediately.

- To reduce the risk of burns, electrocution, fire, or injury to persons:

1. A product should never be left unattended when plugged in.
2. Close supervision is necessary when this product is used by, on, or near children or invalids.
3. Use this product only for its intended use as described in this manual. Do not use attachments not recommended by the manufacturer.
4. Never operate this product if it has a damaged cord or plug, if it is not working properly, if it has been dropped or damaged, or dropped into water. Return the product to a service center for examination and repair.
5. Keep the cord away from heated surfaces.
6. Never block the air openings of the product or place it on a soft surface, such as a bed or couch, where the air openings may be blocked. Keep the air openings free of lint, hair, and the like.
7. Never use while sleeping or drowsy.
8. Never drop or insert any object into any opening or hose.
9. Do not use outdoors or operate where aerosol (spray) products are being used or where oxygen is being administered.
10. Connect this product to a properly grounded outlet only. See Grounding Instruction.
11. Unplug this product before filling. Fill (reservoir) with water only unless otherwise specified by manufacturer. Do not overfill.

**READ ALL INSTRUCTIONS
BEFORE USING**

SAVE THESE INSTRUCTIONS

CONTACT AND WARRANTY INFORMATION

NEW ZEALAND

KOHLER NZ LTD

Free Ph: 0800 100 382

Free Fax: 0800 664 488

www.inglefield.co.nz



For warranty information, please visit our website.

Trusted in New Zealand Since 1982

Englefield