

NAPOLI VESSEL BASIN 570 X 345 NTH

51917.10

victoria ⊕ albert®

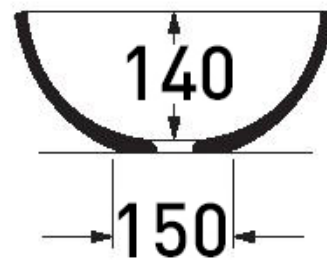
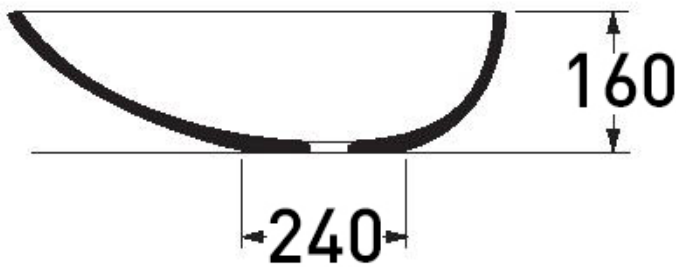
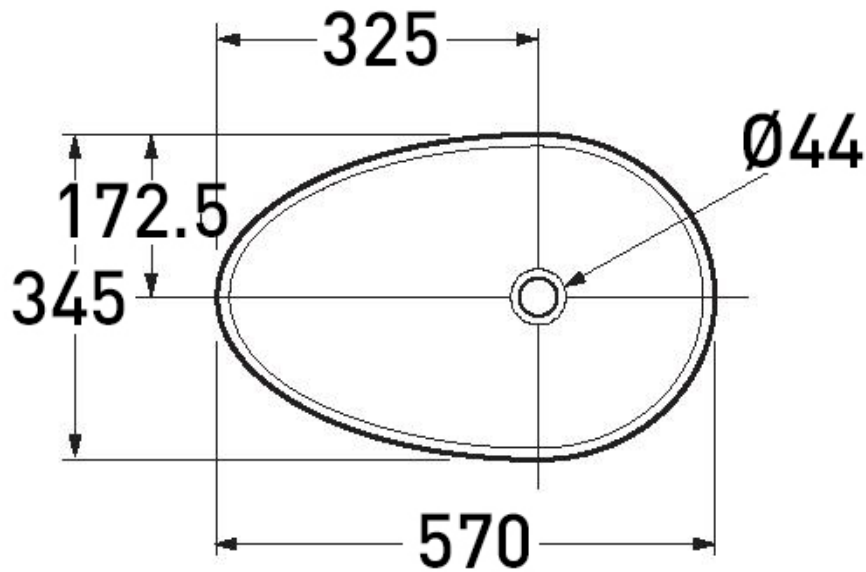

Residential/Light Commercial

Suitable for Residential/Light Commercial Use (Kitchens, Bathrooms and Laundries in Motels, Hotels and Retirement Villages)



Commercial Use

Suitable for commercial use.



Guarantee

25 Year Guarantee



Exterior Painting

Exterior can be painted or personalised.



Taphole

No Tap Hole



Dimensions

570 (L) x 345 (W) x 160 (H)mm



Outdoor Use

Can be installed inside or outdoors.





Quarrycast

QUARRYCAST<sup>®</sup> material is made from a finely ground volcanic limestone and resin mix. 100% one piece, hand finished and packed with naturally desirable properties.



Weight

6KG



Made in South Africa



British owned and operated

Boldly conceived as a low slung single piece shell, the Napoli offers the simplicity of a laid-back design.