



Zenith Miniboil

Models: Boiling/Ambient, Boiling Only



AFFIX PRODUCT LABEL HERE

805757NZ

Before Installation:

- A. Read the instructions.
- B. Note: Not all fittings are supplied with the appliance kit. Isolation valves are not supplied.
- C. The pressure limiting valve must be fitted as part of the kit.
- D. Check the water quality to determine if extra filtration will be required.
- E. Check the appliance rating plate and ensure correct power is available for the appliance.
- F. Check the underbench cupboard supporting the appliance is adequate for the total weight of the appliance, when full of water.

Before Commissioning:

- 1. Check the unit has been secured correctly.
- 2. Flush the supply line before connecting.
- 3. Check all plumbing fittings have been tightened.
- 4. Ensure the outlet and vent pipes are positioned to drain correctly.
- 5. For command centres ensure there is adequate ventilation.
- 6. Check all tubes from the Command Centre to the tap, have a constant rise and there are no 'S' traps or kinks in the hoses.
- 7. Check all electrical connections are correct and there are no loose wires.

Commission:

- 8. Turn on the water and check for leaks.
- 9. Turn on the power.
- 10. Flush 7 - 10 litres of water through the filter.
- 11. Allow sufficient time for the unit to heat up, before using.

WARNINGS AND PRECAUTIONS4

Technical specification 5

Installation requirements 5

Special tools required 6

Installation 6

 Step A - Installing the tap 6

 Step B - Installing the filter 7

 Step C - Installing the Command Centre 7

 Step D - Connecting the water supply 7

 Step E - Connecting the tap 8

 Step F - Testing and commissioning 8

Operation..... 9

Font installation 10

Cleaning 11

End of Life Disposal 11

WARNINGS AND PRECAUTIONS



The power point must be located within reach of its cable. The appliance must be positioned so that the plug is accessible.



Zenith Miniboil Command Centre.

The appliance must be placed on a horizontal surface in an upright position, as shown above.

For continued safety of this appliance it must be installed, operated and maintained in accordance with the manufacturer's instructions. This appliance may deliver water at high temperature. Refer to the Plumbing Code of Australia (PCA), local requirements and installation instructions to determine if additional delivery temperature control is required.

- All plumbing must comply with AS3500.4.1 & AS3500.4.2
- All electrical must comply with AS3300 wiring rules

Safety

This appliance is not intended for use by persons (including children) with reduced physical, sensory or mental capabilities, or lack of experience and knowledge, unless they have been given supervision or instruction concerning use of the appliance by a person responsible for their safety. Children should be supervised to ensure they do not play with the appliance

Qualifications

If any power cord or plug is damaged it must be repaired only by a qualified technician. To avoid hazards, all installation procedures must be carried out by a suitably qualified trades person. The power cord and general power outlet must be in a safe visible position for connection.

Venting

Sometimes steam and / or boiling water may discharge through a vent outlet at the mouth of the tap. If the tap is not installed using the Font pedestal, ensure the tap body is located so the tap outlet safely drains into the sink bowl area.

Lifting

Take care when lifting the Command Centre. Some units may exceed safe lifting limits. Do not lift without assistance. The weights of the units are given in the table under the heading "Installation Requirements".

Airflow

The ambient temperatures this unit should operate within are 5°C - 35°C. The system will operate satisfactorily only if the recommended air gaps are provided, as noted in the installation procedure.

Intended use

This appliance is intended to be used in household and similar applications such as: staff kitchen areas in shops, offices and other working environments; by clients in hotels, motels and other residential-type environments; catering and similar non-retail applications.

Frost protection

If this appliance is located where the ambient air temperature could fall below 5°C, do not turn off the appliance electrically. This safeguard does not offer the same protection to the connecting pipework and fittings.

WARNINGS AND PRECAUTIONS

Installation environment considerations

This unit is intended for indoor use only and should never be installed outdoors or exposed to the elements of nature. This unit must not be positioned in an area that may be cleaned by a water jet. This unit must not be cleaned by a water jet.

Technical specification

MODEL	Miniboil BA, Miniboil BO
Capacity	1.8 Litres
Power rating	1500 Watts
Width x Depth x Height (mm)	212 x 269 x 338
Weight (dry)	6.5 kg
Weight (full)	8.3 kg

Installation requirements

Before installing ensure that the following have been provided at the installation site:

- Sufficient space in the cupboard to install the command centre in accordance with these Installation Instructions.

NOTE: Allow clearance of 50 mm around all sides and 200mm above the command centre for air circulation.

- A water supply connection with isolating valve inside the cupboard within reach of the 750 mm flexible connection and positioned so that the connection point and the stop cock will not be obstructed when the command centre is installed.
- Power supply 220-240 Volt AC, for connection to the appliance via a 10 amp G.P.O.
- Cold water supply with a minimum working pressure of 150 kPa and a maximum working pressure of 700 kPa connected via an isolation valve.
- A 350kPa pressure limiting valve/DNR is supplied with the filter kit and must be installed.



IMPORTANT! Do not proceed with the installation if these requirements are not met.

Special tools required

In addition to normal tools, the following will be required:

- 35mm diameter sheet metal hole punch for sink tops (not supplied)
- 35mm diameter hole saw for timber bench tops (not supplied)
- Nut runner tube spanner (supplied) for fixing tap assembly.

Installation

Step A - Installing the tap



The vertical distance between the base of the Tap assembly and the top of the Command Centre must be BETWEEN 400 - 900mm. Failure to install within these parameters may result in poor water delivery.

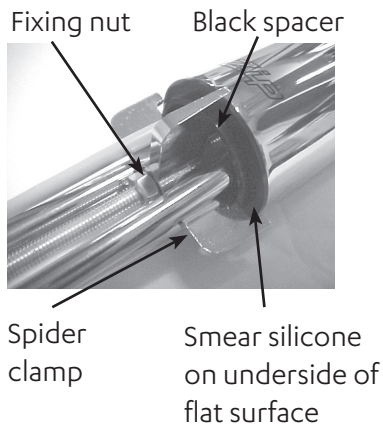

1. Make sure that the tap location will allow the nozzle to drain into the sink.
2. Cut a 35mm hole in the bench / sink top.
3. Install the black plastic spacer to the base of the tap and ensure it remains in place as this is the moisture seal against the bench / sink top. A light smearing of silicon sealant on the underside of the spacer will ensure a watertight fit.
4. Pass the hoses through the 35mm hole and carefully locate the Head Assembly and black spacer on the bench / sink area.
5. From the underside of the bench / sink area re-locate the S/S washer and "Spider Clamp" by feeding each of the tubes and electrical cable evenly in between the legs of the "Spider Clamp". Slide it up to meet the "All Thread", and pass the "All Thread" through the centre of the "Spider Clamp".
6. Hold the "All Thread" steady and re-fit the 6mm nut to the "All Thread" using the tube spanner supplied in the kit. Check the Tap Head position before securing it tightly against the bench / sink top.

Under no circumstances should the Tap be twisted after the installation is complete.

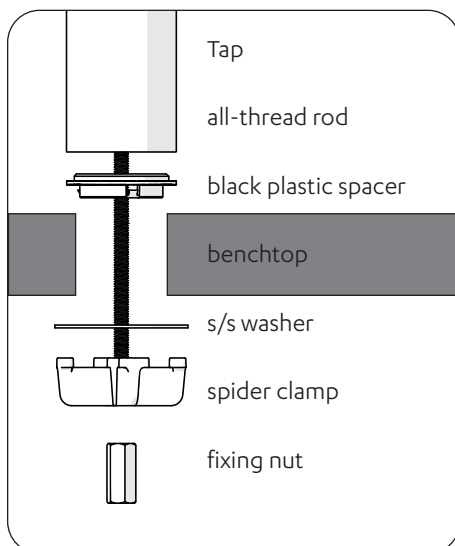

Step B - Installing the filter

Miniboil is supplied with an external filter (see diagram below). It is important the filter be securely fixed adjacent to the under sink unit in such a manner as to allow for easy access to the filter, for service and regular replacement.

The ¼" LDPE tube supplied must be carefully measured and cut to allow for the connection of the filter, double check valve and JG fittings.

Step C - Installing the Command Centre

Position the Command Centre as close as possible to the tap.

The connection tubes supplied with the tap assembly CANNOT be lengthened.

Allow at least a 50 mm air-gap to the RHS for air circulation.

Allow a 70 mm clearance on the LHS of the appliance to ensure the power lead is free from external force.



IMPORTANT: Proper air circulation and adequate cupboard ventilation is necessary for efficient operation.

Adjust cupboard door hinges and attach the supplied silicone door buffers to create a 4 mm air-gap between the doors and the cupboard. This is the minimum ventilation requirement for low usage installations. Failure to do this may cause the appliance to overheat and operate inefficiently.

Step D - Connecting the water supply

To prevent sediment from the in-wall plumbing entering the Command Centre at connection, flush water through the supply line thoroughly before connection.

Filter assembly sequence: (see Fig 2)

Fit the pressure limiting valve to the outlet side of the isolating valve (not supplied).

Mount the filter and flush valve assemblies in a convenient position using the angle bracket supplied.

Connect the filter assembly plumbing between the pressure limiting valve and the inlet of the Command Centre using the ¼" JG fittings supplied (see Fig 1). Take note of the flow direction, marked with an arrow on the top of the filter head.

Ensure the flush valve is accessible after installation as this will be required to flush water through the filter, when the filter is installed or changed.

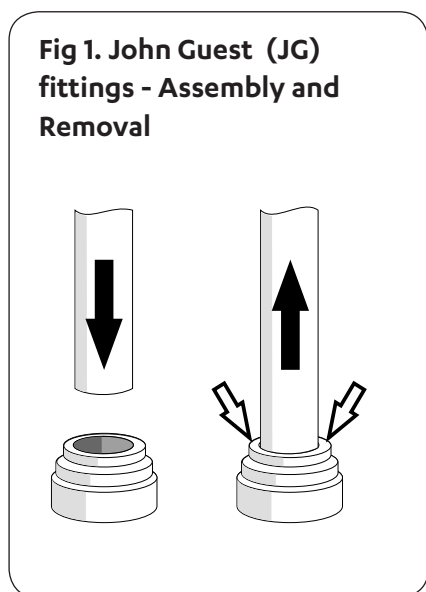

Fig 1. John Guest (JG) fittings - Assembly and Removal

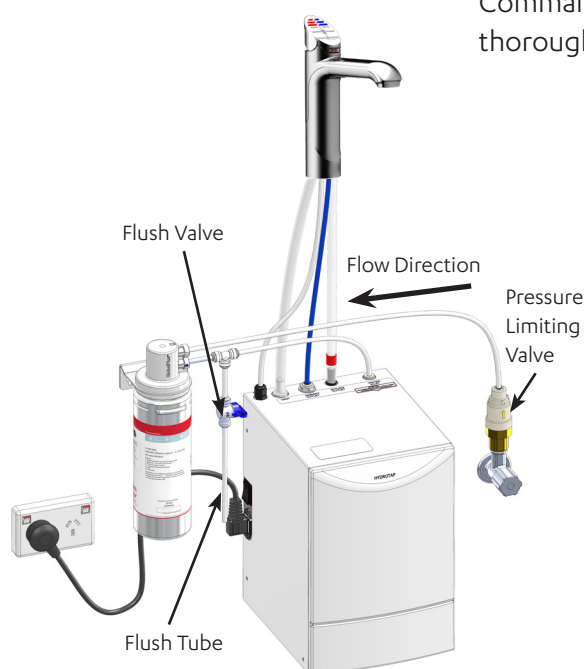
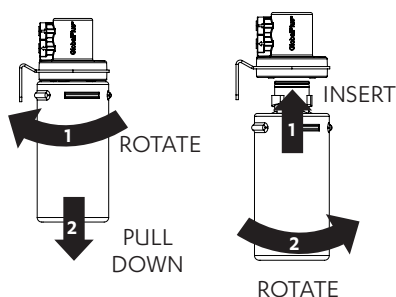

Fig. 2 External Filter Connection

Fig 3. Cartridge replacement



Cartridge Removal

Cartridge Insertion

Filter insertion and replacement (Fig 3)

Align the tabs of the cartridge with the filter housing and insert it up into the socket.

Turn the cartridge a quarter turn to the right until it locks into position. Reverse this procedure for removal.

Step E - Connecting the tap

- **Trim excess silicone tubes to ensure a continuous fall back to the Command Centre.**
- **New hose sets supplied with the unit should be used. Do not use old hose sets.**
- **Do not loop or allow sagging or kinking of the tubes, to prevent water from being trapped inside.**
- **When connecting, slide the tube over the pipe at least 15mm.**

Measure and trim the Red silicone tube and connect it to the BOILING outlet located on the top of the Command Centre.

Measure and trim the CLEAR silicone tube and connect it to the vent outlet located on the top of the Command Centre.

For Boiling Ambient models, measure and trim the blue LDPE tube and connect it to the AMBIENT outlet located on the top of the Command Centre (see Fig 4).

Connect the tap USB connector to the USB lead on the Command Centre. It should be fitted together tightly until a "click" is felt. Failure to fully insert the connector will prevent tap operation. Once connected, fix the cable to the wall, ensuring it is off the floor and away from any possible water splashes.

Turn on water and check for leaks.

Step F - Testing and commissioning

The appliance is now running in normal operating mode. The Red LED will flash until factory set temperature is reached.

Filter flush

When commissioning, it is advisable to flush the filter for several minutes to remove any fine filter particles. Use a bucket to collect and dispose of the waste water.

To flush the filter, first turn on the water supply and then turn on the flush valve (see Fig 6.). Discharge approximately 7.5L of water into the bucket.

Once the filter has been flushed, turn the flush valve off.

Wait 5 minutes after this point to allow adequate fill time.

The unit is now ready for use. Test water delivery from the tap and check for appropriate temperatures. Use cable clips to tidy and secure wiring.

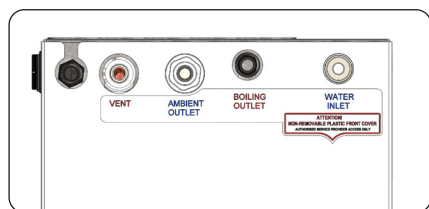

Fig 4. Boiling/Ambient models: Connection viewed from the top

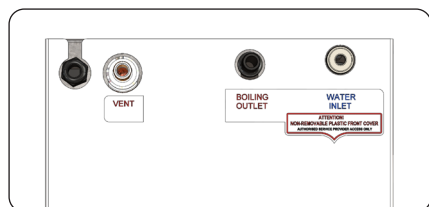
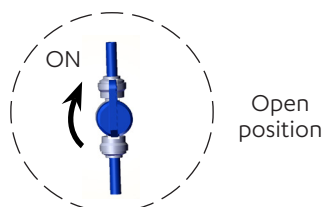
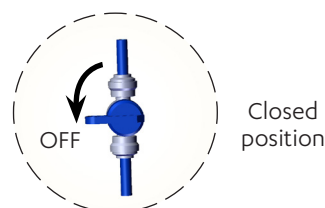

Fig 5. Boiling Only model: Connection viewed from the top

Fig 6. Flush Valve



Open position



Closed position

Operation

Boiling Only model:

Press or pull either red lever, and cover the Safety button at the same time.



Boiling water will be dispensed.

Boiling water (BA model):

Press or pull the red lever, and cover the Safety button at the same time.



Boiling water will be dispensed.

Cold (ambient) water (BA model):

Press or pull the blue lever.



Cold water will be dispensed.

Note: If the appliance has not been used for several days, allow the tap to run ambient water for about one minute.

Tap Operation

Press the RED lever and the SAFETY button to dispense boiling water.

Pull the RED lever up while holding the SAFETY button to dispense boiling water continually. The water will flow for about 15 seconds. Then manually return the lever to the off position.

Press the BLUE lever to dispense cold/ambient water (Boiling Ambient model). Pull the lever up to dispense ambient water continually. The water will flow for about 15 seconds. Then manually return the lever to the off position.

Tap Lights

Red LED: Boiling water

- Steady light: boiling water is ready and can be dispensed.
- Flashing: the water temperature is below the set value of 93°C, or appliance is in Sleep mode.

Blue LED: Cold (ambient) water (for BA model only)

- Steady light: ambient-temperature water can be dispensed.

All LEDs: Fault

- Flashing: there is a fault in the unit. In that case, switch off the unit for at least 20 seconds. If the fault has not been corrected when the unit is switched on again, contact customer service.

Change Filter light (Boiling Ambient model ONLY)

- Off: Indicates the water filter is operating within its normal specified lifespan.
- Flashing slowly: Indicates the water filter is due for replacement, after 12 months of use or after dispensing 4000 litres, whichever occurs first. To replace the filter, refer to Fig 3. After the filter is changed, it should be flushed. Refer to Filter flush on previous page.
- Reset filter counters: After filter is changed, hold down BOTH LEVERS for 10 seconds. The Filter Change light will turn ON, and after 10 seconds will turn OFF. This will reset the filter counters to zero.

Change Filter light
(Boiling Ambient model)



Operation

Activate / deactivate sleep mode (BA model):

Press the blue lever and the Safety button and hold them for about five seconds.



LEDs light up simultaneously when sleep mode is activated.

LEDs light up alternating when sleep mode is deactivated.

Sleep mode (Boiling Ambient model ONLY)

Miniboil can be set to Sleep mode to save energy. If Sleep mode is enabled, the appliance will switch to Sleep if it has not been used for two hours. The water temperature will be maintained at 64 °C and the LEDs will flash slowly. Operation of the tap during this time will wake the system from sleep and the water will start heating up again. Boiling water is available as soon as the red LED shows a steady light.

Press the BLUE lever and the SAFETY button and hold them for about 5 seconds to enable or disable Sleep mode.

The red LED and the white LED will flash simultaneously to confirm that Sleep is enabled. They will flash alternately to confirm that Sleep is disabled.

Long period of non-use

Note: In ambient / warm water, microorganisms can multiply faster. It is recommended to leave your drinking water system switched on even during long periods of non-use.

If you still want to shut down your drinking water system for an extended period of time, proceed as follows:

1. Turn off the water supply.
2. Use the tap to dispense ambient and hot water until no more water flows to empty the system.
3. Disconnect the appliance from the power supply.

After prolonged non-use

1. Reconnect the water supply. Pay attention to any leaks.
2. Reconnect the appliance to the power supply.
3. After non-use of several days: Drain at least four litres of ambient water from the fitting. If necessary collect the water in a suitable container. As soon as the LED in red lever lights up continuously, drain hot water. Repeat this process until the LED flashes again.

CAUTION! Hot water will be dispensed.

4. The appliance is now ready for use.

Font installation



A font kit is available for this product, sold separately as an accessory. For details of the available font kits, please contact your Zenith customer service provider. The font installation instructions and mounting template are supplied with the font kit.

Part No. 90915NZZ00: Font Kit, Chrome

Troubleshooting

Symptom	Possible Cause	Solution
No LED display, no tap head lights or, no water when tap is operated.	No power. Plug is not located in power socket. Tap loom is not connected to the unit. Possible internal fault.	Check power supply. Ensure power plug is correctly fitted and switch is turned ON. Check loom connection. Contact local Zenith Service Provider.
No water flow.	Water supply isolated. Water supply not connected. Power supply not connected. Tap loom is not connected to the unit. Possible internal fault.	Check water supply is on. Check to ensure plumbing connection is made. Check power plug is correctly fitted and switch is turned on. Check for loom connection.
Slow water recovery after use.	Unit is in Sleep Mode. Possible internal fault.	Touch Hot lever and wait for Red LED to stop flashing. Wait for Red LED to stop flashing. Contact local Zenith Service Provider.
All the lights are flashing	Power interruption Water interruption System Fault	Turn OFF power for 20 seconds and then turn back on. Check for blockages Contact local Zenith Service Provider

Cleaning



Do not use strong, corrosive, spray or abrasive cleaners. Clean with a soft cloth or brush and mild soap and water.

Do not spray water over the tap as it may damage the low-voltage electronics.

Command Centre units must never be cleaned with water jets.

End of Life Disposal

In order to help preserve our environment we ask that you dispose of this product correctly. Please contact your local city council for collection centre details.

Zenith Heaters Limited

IRD/GST No. 95 640 729
18 Kawakawa Place, Westgate, Auckland 0814
New Zealand
Ph: +(64 9) 838 8612 | Free Call 0800 558 055
zenithwater.co.nz

The terms “Zenith” and “HydroTap” are registered trade marks of Zenith Heaters Ltd. Zenith products described in this publication are manufactured under one or more patents and further patent applications are pending.

As Zenith policy is one of continuous product improvement, changes to specifications may be made without prior notice. Images in this booklet have been modified and may not be true representations of the finished goods.

© 2021 Zenith Heaters Ltd.

