

AWA WASHING MACHINE TAP

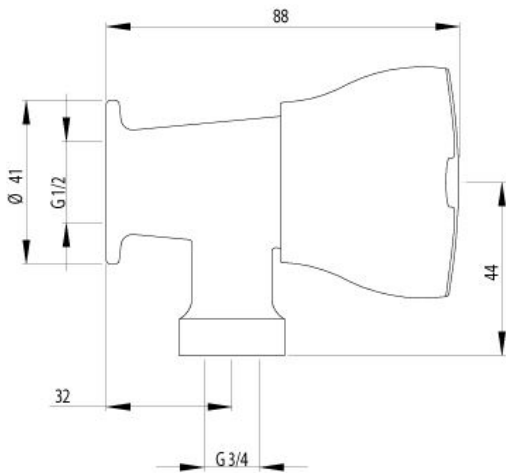

CONSTRUCTION: Brass body

CLASSIFICATION: Suitable for **all pressure** systems

INLET CONNECTIONS: 1/2" BSP Female

OUTLET CONNECTIONS: 3/4" BSP Male

WORKING PRESSURE: 10 - 500kPa

DIMENSIONS FOR FITTING: 48mm diameter hole

OPERATING TEMPERATURE: 5 °C - 80 °C

- Solid metal handle.
- Standard non-rising headworks.

AW413FWM

Chrome

<http://www.methven.com/nz/awa-washing-machine-tap>